

INSTALLATION INSTRUCTIONS

Bridgeport Tub Seat
LIFESTYLE & WELLNESS®

This seat should be installed as an assembled unit.

PLEASE READ THESE INSTALLATION INSTRUCTIONS THOROUGHLY PRIOR TO INSTALLING THE SEAT TO IDENTIFY THE TOOLS RECOMMENDED FOR INSTALLATION, AS WELL AS THE MOUNTING HARDWARE REQUIRED TO COMPLETE THE INSTALLATION.

IMPORTANT: THIS PRODUCT SHOULD ONLY BE INSTALLED BY QUALIFIED AND TRAINED PERSONNEL

FAILURE TO FOLLOW THESE INSTRUCTIONS COULD LEAD TO IMPROPER INSTALLATION OF THE TUB SEAT, STRUCTURAL AND/OR WATER DAMAGE TO THE WALL AND IN-WALL SUPPORT STRUCTURES, AND/OR SERIOUS BODILY INJURY IN USE. IN ADDITION, ALL WARRANTIES, EXPRESS OR IMPLIED, WILL BE NULL & VOID DUE TO IMPROPER INSTALLATION OF THIS PRODUCT. THE MANUFACTURER DOES NOT ASSUME ANY LIABILITY FOR DAMAGE RESULTING FROM SERVICES PERFORMED BY OTHERS, OR FAULTY INSTALLATION, MISUSE OR MISAPPLICATION OF GOODS.

MAXIMUM WEIGHT CAPACITY FOR THIS PRODUCT SHALL NOT EXCEED 250 LBS. WHEN PROPERLY INSTALLED.

1. Remove the Bridgeport Tub Seat and four (4) Positioning Stops (packed separately) from the shipping carton.

Attach all four (4) Positioning Stops to bottom of seat by screwing them onto the exposed studs in a clock-wise direction. Leave Positioning Stops loose enough to slide freely along the length of the slot in the frame.

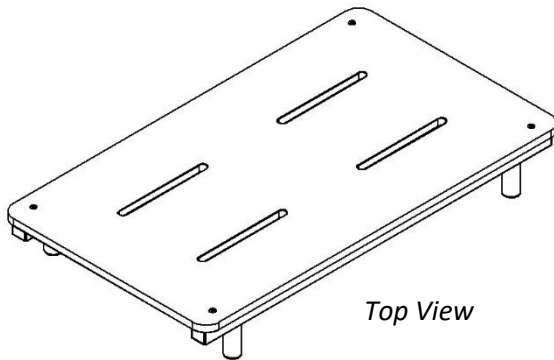

Top View

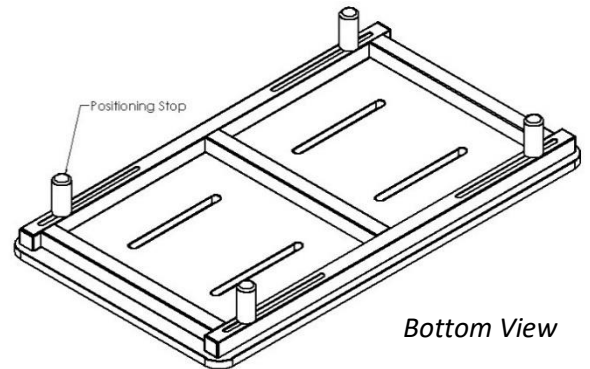

Bottom View

STSB-270155-One Piece Phenolic Series

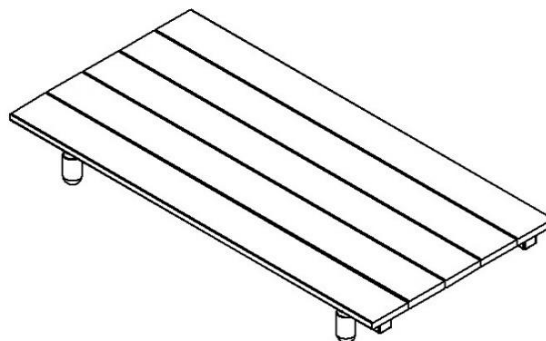

STSB-300150-Natural Teak Wood Series

2. Locating and mounting the tub seat in the desired position.

Place the seat in its desired position in the tub enclosure.

The Positioning Stops will slide along the bottom of the seat frame to accommodate various tub dimensions. Position the seat so that the Positioning Stops rest securely inside the tub dam.

This seat MUST be evenly spaced on the top of the tub dam and a minimum 2" surface contact MUST be maintained on both sides of the seat (see diagram below).

Hand tighten all four (4) Positioning Stops by rotating each one clock-wise until firmly tightened. Do **NOT** over-tighten.

Always ensure each of the four (4) Positioning Stops are securely tightened and fit snug against the inside of the tub when this seat is in use.

WARNING:

Serious damage to existing structures and/or physical harm could occur if this product is not used properly. Do NOT stand on the seat at any time.

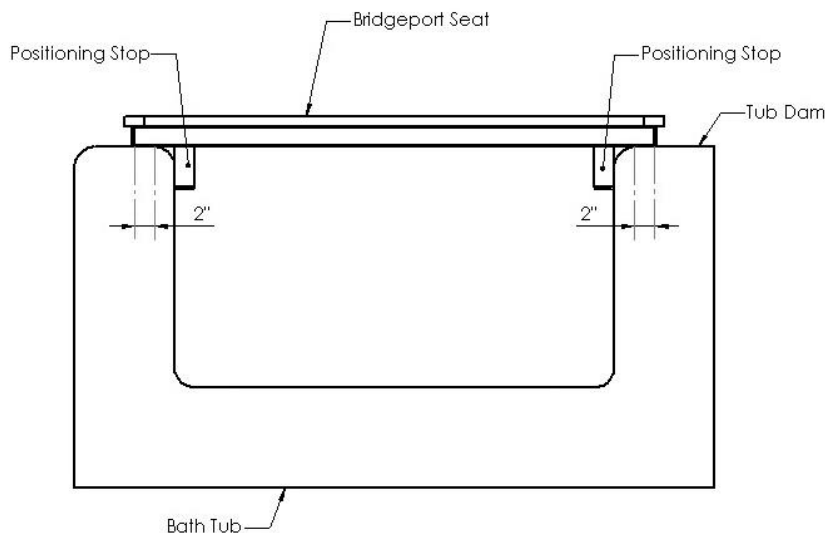
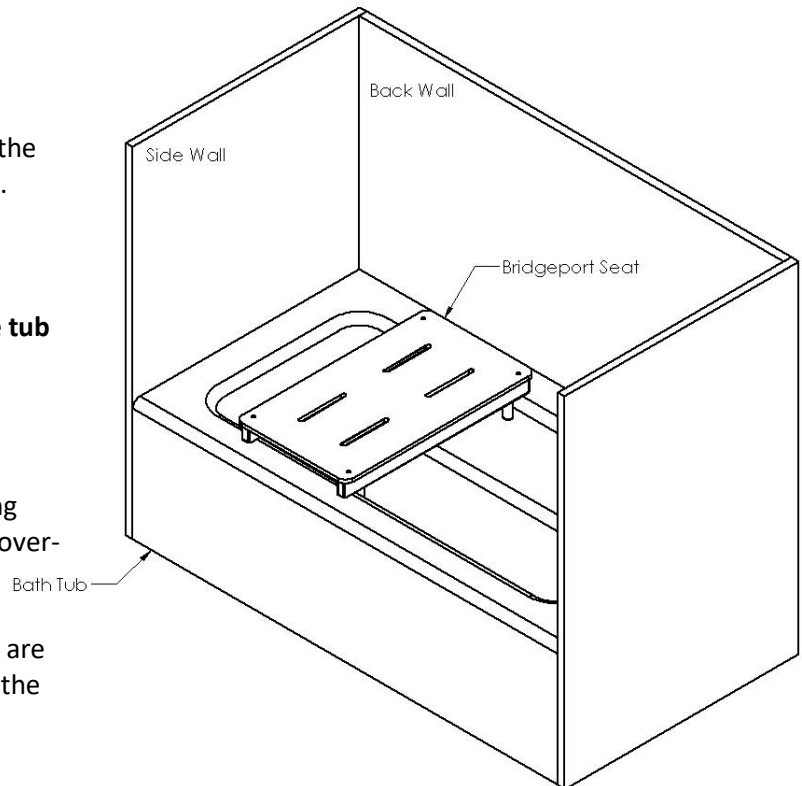

To remove this seat, carefully lift it from its set position on the tub and store in a clean, dry location for future use.

Once secured to the tub, make certain the seat does not shift from its set position in any direction before use.

THIS COMPLETES THE INSTALLATION OF THE BRIDGEPORT TUB SEAT.

NOTES:

1. PART GEOMETRY IS DEFINED BY CAD MODEL PROVIDED BY ENGINEERING.
2. AESTHETIC DIMENSIONS SHALL NOT AFFECT FIT AND FUNCTION OF PART.
3. DIMENSIONS IN BRACKETS [] ARE MILLIMETERS AND FOR REFERENCE ONLY.

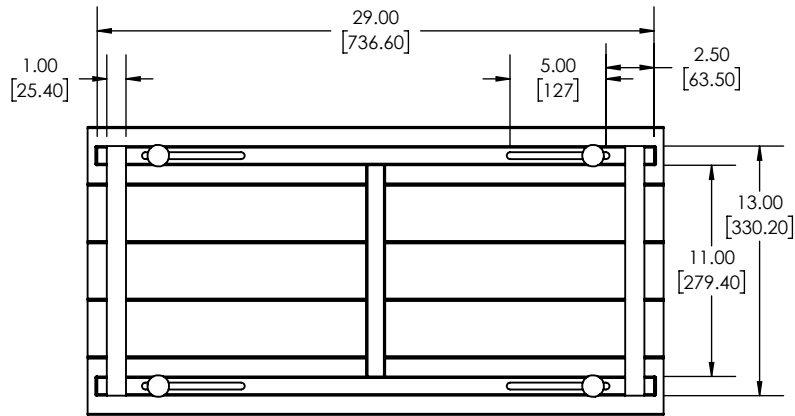
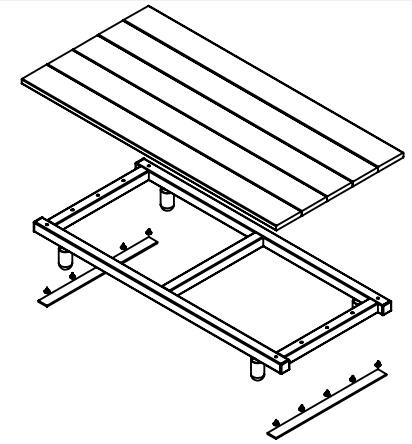
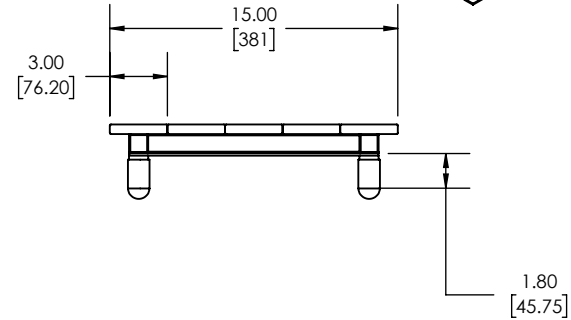
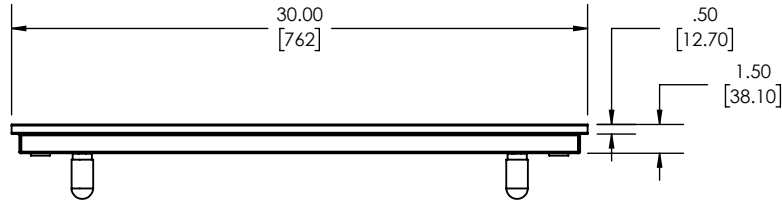

Proprietary & Confidential

This drawing and the information contained herein is the property of Seachrome Corporation and shall not be reproduced, copied, or disclosed in whole or in part, or used in manufacturing, or for any other purpose without the written permission of Seachrome Corporation.

INTERPRET GEOMETRIC TOLERANCING PER: ASME Y14.5-2009
 UNLESS OTHERWISE SPECIFIED:
 DIMENSIONS ARE IN INCHES [MM]
 TOLERANCES: DECIMALS
 FRACTIONAL ±1/64 .X ±0.1
 ANGLES ±1° .XX ±0.01
 BEND ±1° .XXX ±0.005
 (XX) DENOTES CRITICAL DIMENSION
 ALL THREADS ARE CRITICAL
 REMOVE ALL BURRS & SHARP EDGES
 MATERIAL Material <not specified>
 FINISH SEE NOTE

TESTING	-----	-----
ASSEMBLY	-----	-----
POLISHING	-----	-----
MACHINING	-----	-----
TOOLING FIXTURE #	-----	-----
NEXT ASSY		USED ON
APPLICATION		
DRAWN	E. BARBER	09/10/21
CHECKED	J. AMOZOC	09/10/21
ENG APPR.	J. AMOZOC	09/10/21
MFG APPR.	R. CANO	09/10/21
Q.A.	-----	XX/XX/XX



1906 EAST DOMINGUEZ
 LONG BEACH, CA 90810
 (310) 427-8010

CORPORATION

TITLE:		REMOVABLE TUB SEAT, 30" X 15" ADJUSTABLE POSTS	
DWG. NO.	STSB-300150-TWA	REV B	
DO NOT SCALE DRAWING	SIZE A	SCALE: 1:10 SHEET 1 OF 1	

ZONE	REV	ECN NO./DESCRIPTION	DATE	APPROVED
B		HARDWARE FROM UNDER	05/12/22	E.B.
A		RELEASED	09/10/21	E.B.

4

3

2

1