



California Faucets®

Palomar®

TRADITIONAL SINGLE HOLE FLOOR MOUNT TUB FILLER WITH HANDSHOWER

Features

- Available in 28 finishes including 13 PVD finishes
- All brass construction
- No additional wall or trap stabilizer kit required
- Tub filler: Maximum flow rate: 10 gpm (37 L/min) at 60 psi
- Handshower: Flow rate: 2.0 gpm (7.6 L/min) or 1.8 gpm (6.8 L/min)
- Ceramic mixing cartridge
- Handshower holder may be adjusted forward during installation
- Rough valve sold separately (9511)

Codes/Standards Applicable

Product meets or exceeds the following:

- ASME A112.18.1/CSA B125.1
- CEC (1.8 gpm) / DOE (2.0 & 1.8 gpm)
- Commonwealth of MA
- EPA WaterSense handshower (2.0 gpm)
- ADA compliant (with lever handles)
- Local codes may require installation of an upstream tempering valve

1311-XX.20
1311-XX.18



1311-36.FR shown



XX = DENOTES HANDLE SERIES

DIMENSIONS, in.[mm]		
HANDLE OPTIONS	A	B
33	15 3/16 [100]	7 5/16 [138]
35	15 3/16 [100]	7 5/16 [138]
36	5 3/8 [92]	3 5/8 [136]
48	11 3/16 [94]	3 5/8 [136]
55	13 3/16 [98]	5 5/16 [135]
64	15 3/16 [101]	5 5/16 [136]
68	13 3/16 [97]	5 5/16 [135]
CLEV	4" [101]	7 5/16 [138]
H34	1 1/8 [29mm]	11 5/16 [144mm]
H38	15 2/16 [74]	13 6/16 [173]
H42	1 3/8 [79]	7 6/16 [164]
H46	7 3/16 [87]	3 6/4 [172]
H47	1 3/8 [35]	9 5/16 [142]
H48X	1 1/2 [38]	5 5/2 [140]
H59	15 2/16 [74]	13 6/16 [173]
H60	3 1/8 [35]	9 5/16 [142]
H63	5 6/16 [160]	15 5/16 [152]
H67	3 1/8 [35]	11 5/16 [144]
H69	1 3/2 [89]	5 6/16 [160]

THROUGH-HOLE SPECIFICATIONS			
	MIN	RECOMMENDED	MAX
MOUNTING FLANGE:	Ø3-11/16" [94]	Ø3-11/16" [94]	Ø3-15/16" [100]

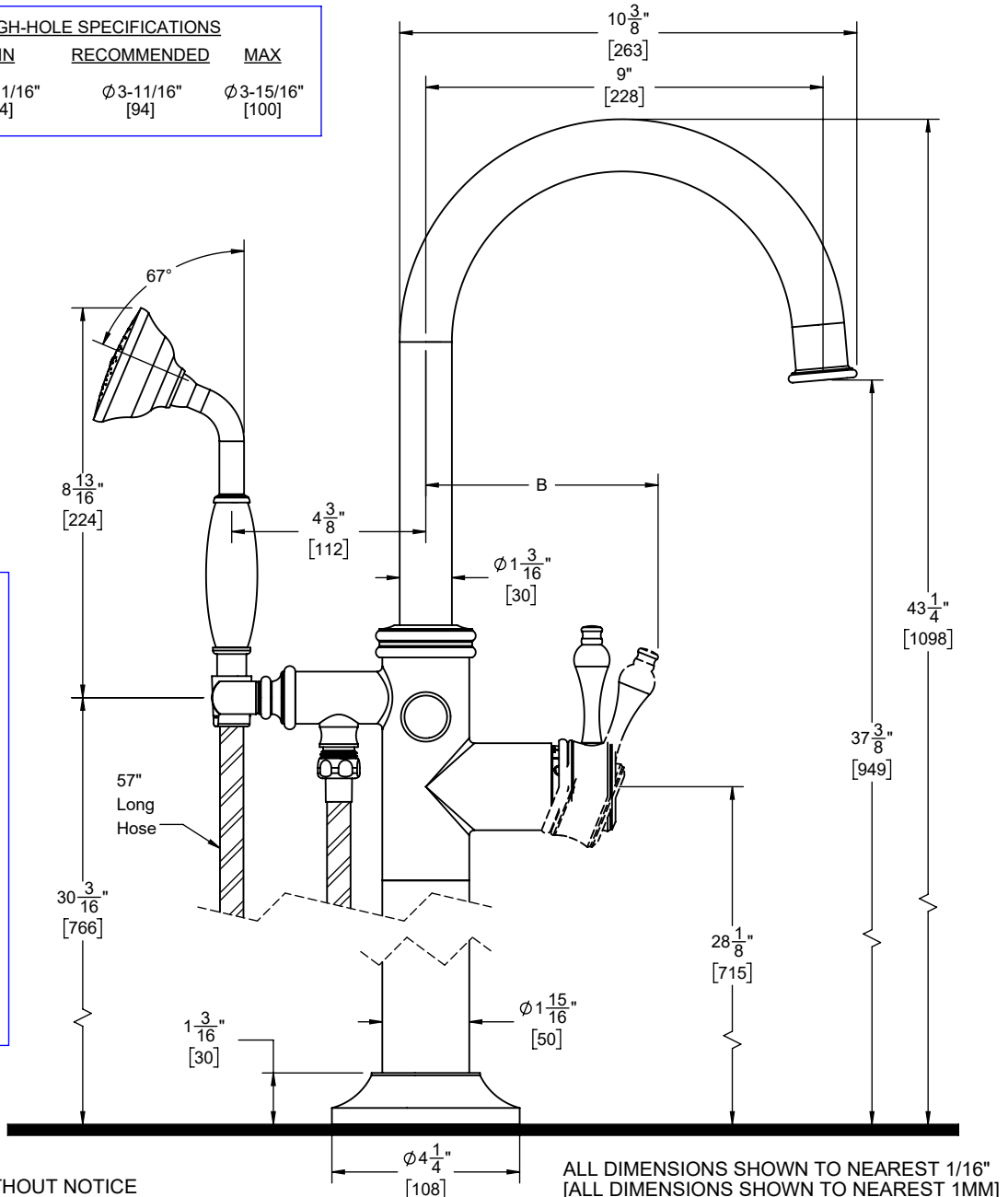
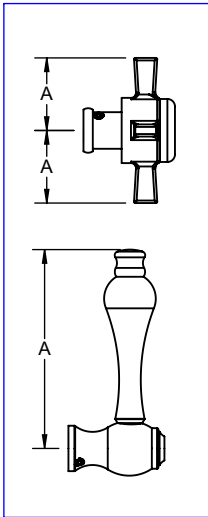

SPECIFICATIONS SUBJECT TO CHANGE WITHOUT NOTICE

ALL DIMENSIONS SHOWN TO NEAREST 1/16"
[ALL DIMENSIONS SHOWN TO NEAREST 1MM]



California Faucets®

09113-XX, 1011-XX, 1111-XX, 1211-XX,
1311-XX, 1411-XX, 7711-XX, 8511-XX, 8611-XX
Single Hole Tub Filler – trim only
Installation Instructions

CALIFORNIA FAUCETS RECOMMENDS THAT ALL PLUMBING PRODUCTS BE INSTALLED BY A LICENSED PROFESSIONAL

IMPORTANT: Read all instructions prior to installation and provide copy of instructions to consumer.

Operating Specifications:

Recommended Supply Pressure: 20 to 70 psi**†

Maximum Flow Rate: 10 gpm

* Operating pressures between hot and cold supplies should vary no more than 30 psi.

† If water pressure exceeds 70 psi, install a Pressure-Reducing Valve (RPV).

I PREPARE ROUGH

IMPORTANT: Shut off water supply before starting.

- Remove MUDGUARD (1) by unscrewing SCREWS (2) from inside the MUDGUARD (1) with a 3/16" HEX ALLEN KEY (3)
- Remove PLUG (4) by unscrewing the two SCREWS (5) by using an 1/8" HEX ALLEN KEY (6)

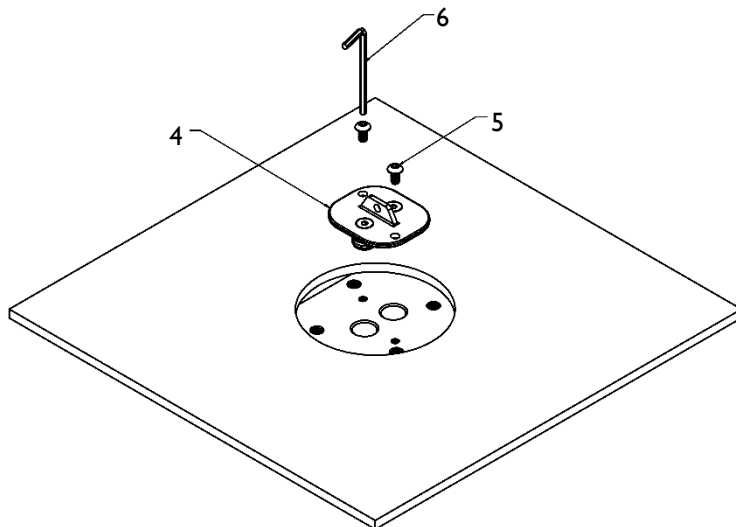
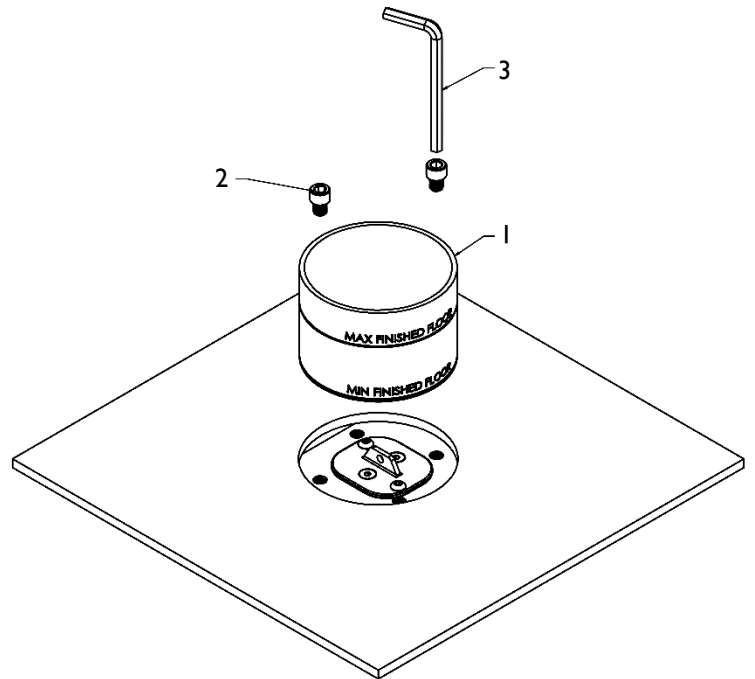

2

ATTACH LEG TO ROUGH

- Slide COVER (7) up LEG (8) to allow enough room to access MOUNTING FLANGE (9)
- Ensure that there is sufficient grease on all O-RINGS (10a) on quick SUPPLY TUBES (10) and insert into the ROUGH (11)
- Hand tighten BOLTS (12) with WASHERS (13) through MOUNTING FLANGE (9) and into the ROUGH (11)
- Using a 3/16" HEX ALLEN KEY (14) securely tighten MOUNTING FLANGE (9) onto ROUGH (11)
- Leave cover up until STEP 4

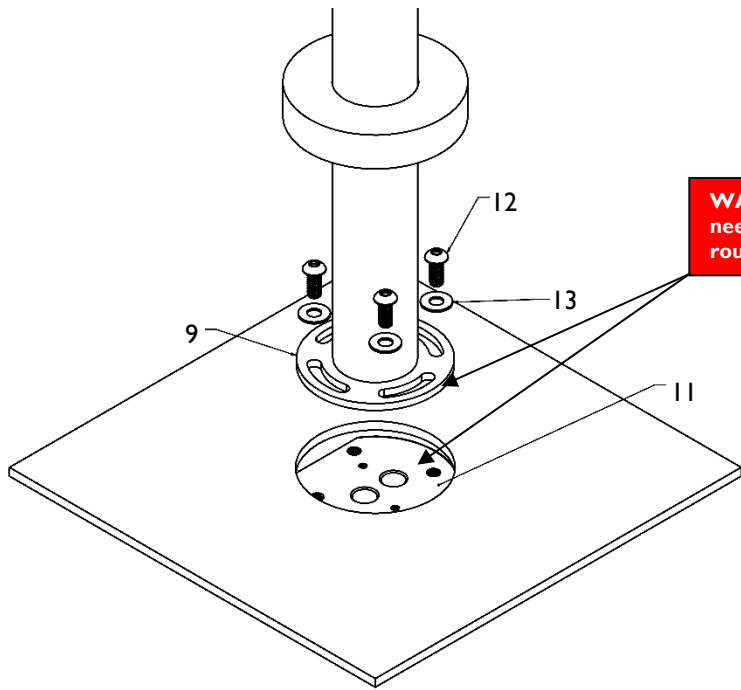
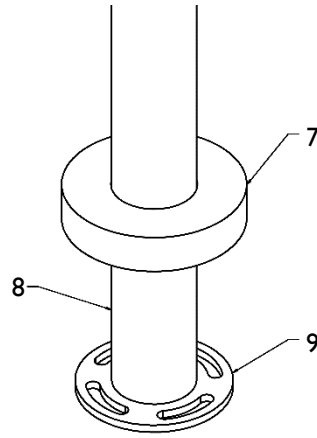

WARNING: Flange needs to be flush with rough to prevent leaks

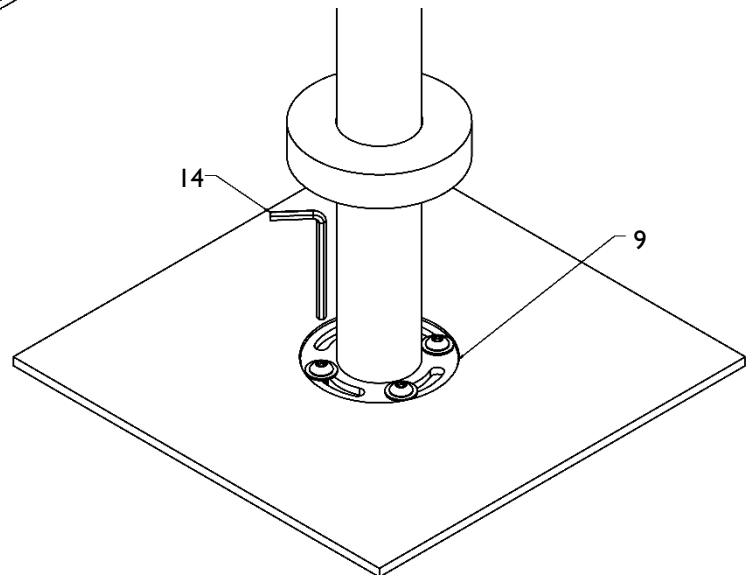
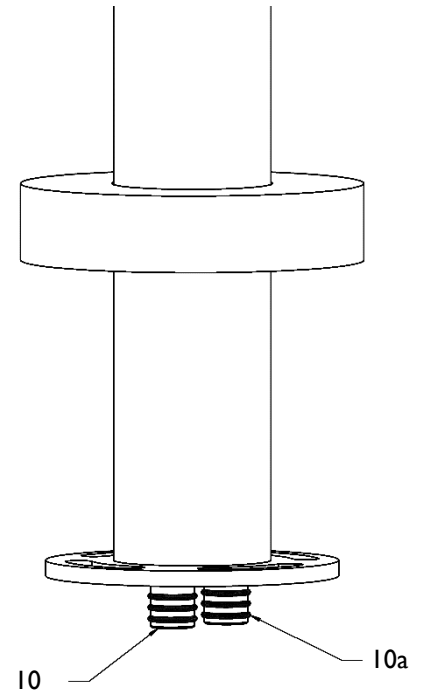

3

FINAL CONNECTIONS

- Attach HEX (15a) nut of HOSE (15) to hose outlet of BODY (16)
- Attach CONICAL (15b) nut of HOSE (15) to inlet of HANDSHOWER (17)
- Rotate SPOUT (18) to desired location then tighten SETSCREW (19) with 3/32" ALLEN KEY (20)
- If desired the angle of the handshower HOOK (21) can be rotated to a different angle
 - Remove SCREW (22) and pull out HOOK (21)
 - Rotate HOOK (21) to desired angle and place back on to STEM (23)
 - Tighten SCREW (22) into STEM (23)

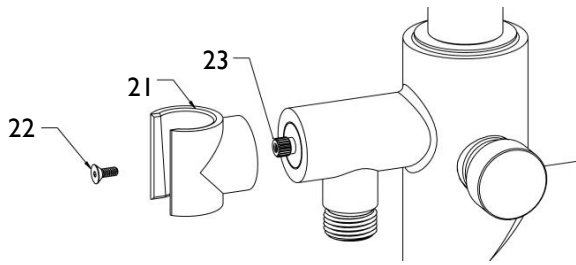
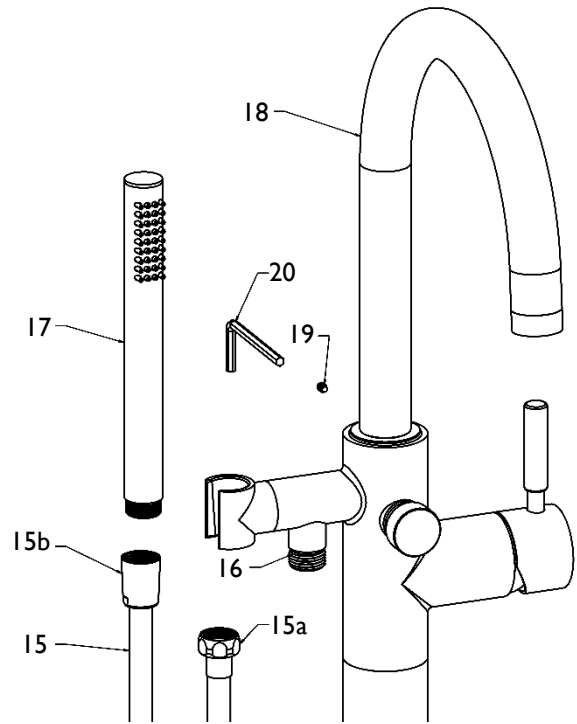

4

TEST SECTION

- Have helper turn on water supply
- Check for leaks around mounting flange
- Operate faucet diverter from tub spout handshower and check for leaks
- Pull HANDLE (24) outward for water flow; water will flow from SPOUT (18)
- Pull diverter KNOB (25) to operate HANDSHOWER (17)
- Slide cover down leg until flush with floor, it may be necessary to twist and rotate cover to aid in proper seating

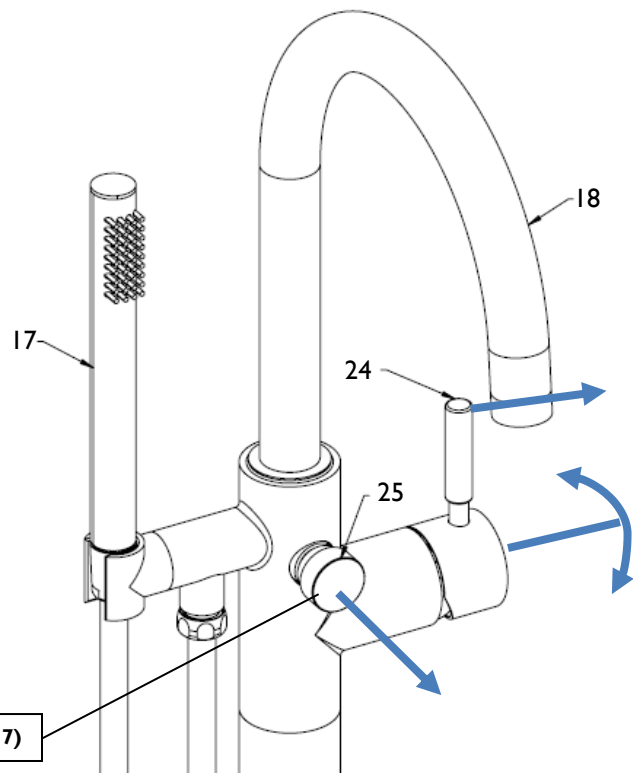

NOTE: PULL to divert to HANDSHOWER (17)



California Faucets® ROUGH VALVE FOR SINGLE-HOLE FLOOR MOUNT TUB FILLER

TUB FILLER

Features

- Forged rough provides solid support for installation in concrete or wood subflooring
- $\Phi 5\text{-}1/2"$ [140] rigid base with pre-drilled screw holes to mount to underlying concrete & wood framing
- 1/2" NPT female inlets
- Includes mudguard & test plug

9511

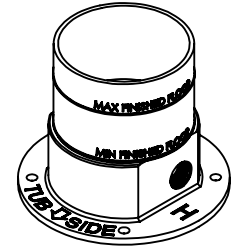

Codes/Standards Applicable

- Meets or Exceeds the following:
- ASME A112.18.1/CSA B125.1

For use with
0911-XX.FR
1011-XX.FR
1111-XX.FR
1211-XX.FR
1311-XX.FR
1411-XX.FR
7711-XX.FR
8511-XX.FR
8511-XXB.FR
8511-XXW.FR
8611-XX.FR
8611-XXB.FR
8611-XXW.FR

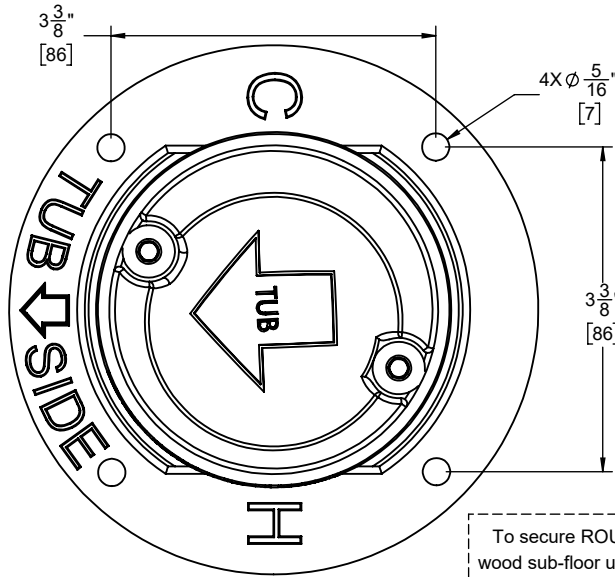

To secure ROUGH to wood sub-floor use wood screws 1/4" X 1-1/4" min length

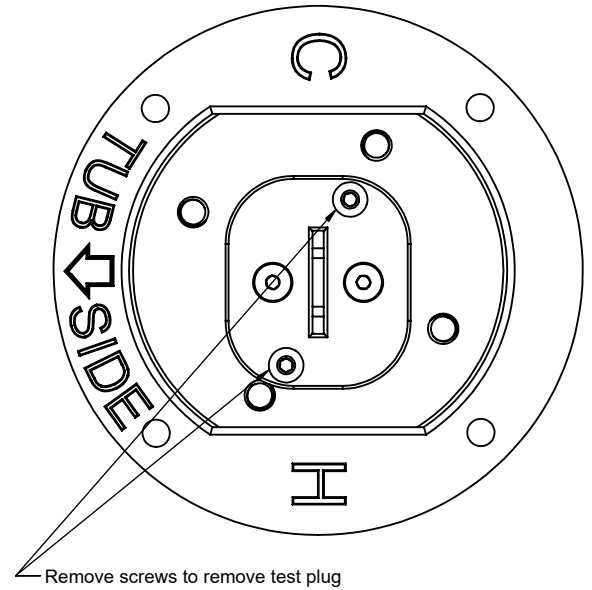

IMPORTANT
Finished Floor opening **MUST** be:
 $\Phi 3\text{-}11/16"$ [93] to
 $3\text{-}15/16"$ [100]

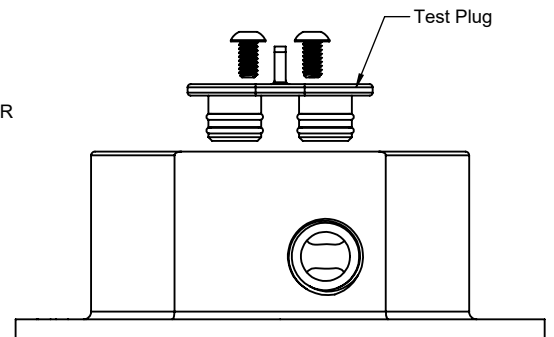
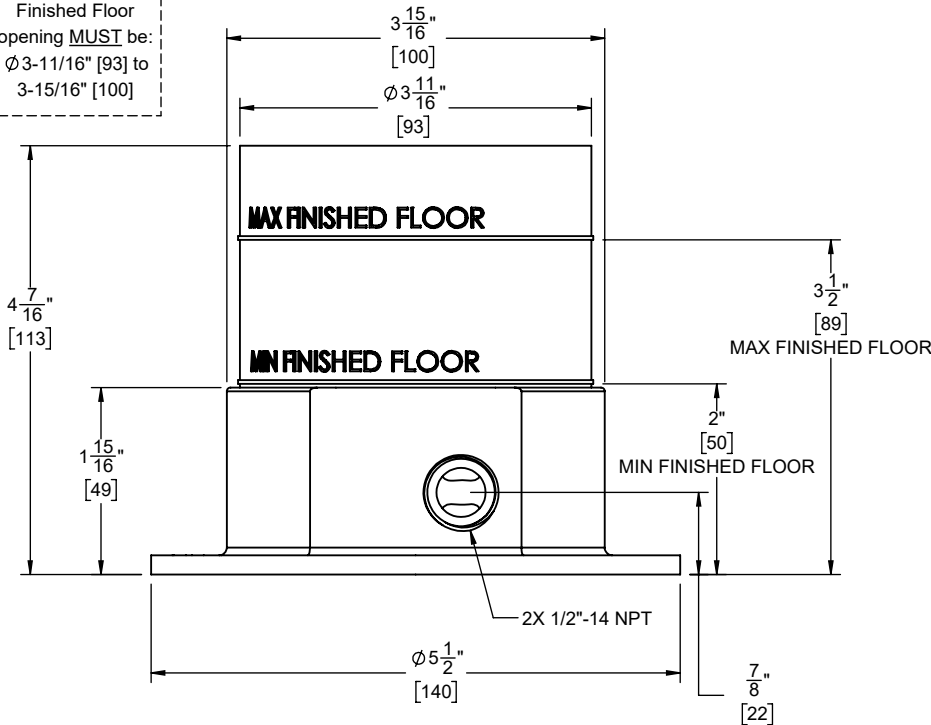

SPECIFICATIONS SUBJECT TO CHANGE WITHOUT NOTICE

ALL DIMENSIONS SHOWN TO NEAREST 1/16"
[ALL DIMENSIONS SHOWN TO NEAREST 1MM]"



California Faucets®

9511

Rough for Floor Mount Tub Filler (for use with 0911-XX, 1011-XX, 1111-XX, 1211-XX, 1311-XX, 1403-XX, 8511-XX, 8611-XX, & 7711-XX)

Installation Instructions

CALIFORNIA FAUCETS RECOMMENDS THAT ALL PLUMBING PRODUCTS BE INSTALLED BY A LICENSED PROFESSIONAL

IMPORTANT: Read all instructions prior to installation and provide copy of instructions to consumer.

DISCLAIMER: To conform to many local codes and/or ordinances, it may be required that this product be installed in conjunction with an approved tempering valve.

Operating Specifications:

Recommended Supply Pressure: 20 to 70 psi[†]

* Operating pressures between hot and cold supplies should vary no more than 30 psi.

† If water pressure exceeds 70 psi, install a Pressure-Reducing Valve (RPV).

I PREPARING SUPPLY NIPPLES

Important: It is the responsibility of the **INSTALLER** to refer to the various installation methods shown in steps 2 or 4 to determine proper rigid copper PIPES (2a) lengths.

- Pre-assemble FITTINGS (2) prior to attaching to ROUGH (3)
- Apply TEFLON TAPE (1) onto threads of FITTING (2) and tighten into ROUGH (3). No more than 3 wraps to male threads of FITTING (2)
- Attach "COLD" INLET to COLD SUPPLY and "HOT" INLET to HOT SUPPLY. All soldering of FITTINGS (2) shall be performed a minimum of 4" away from ROUGH (3)

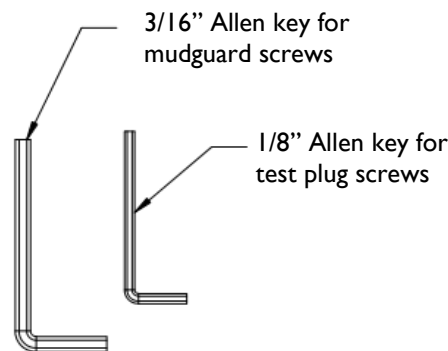
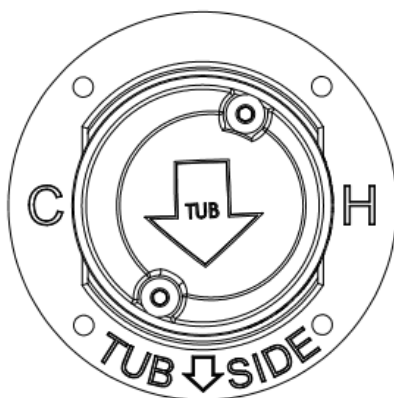
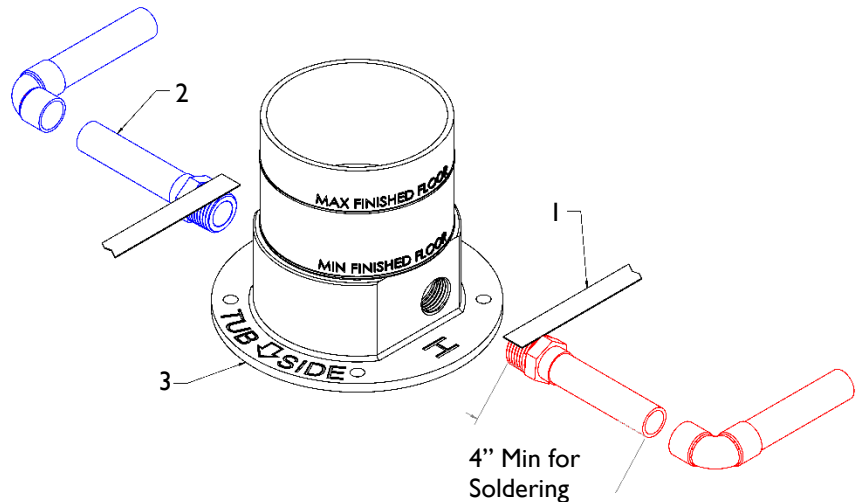

2

INSTALLING IN WOOD FLOOR

- Determine location of tub & faucet prior to proceeding

Important: It is the responsibility of the **INSTALLER** to ensure that the floor rough is properly secured to all sub-floor construction. All local building and plumbing codes and/or ordinances, shall be followed to confirm proper secure installation.

- After determining tub location preparing the floor is necessary to properly support the ROUGH (3) by using 2 x 8 wood cross as a MOUNTING SURFACE (4) which are attached floor JOIST (5)

Important: It is the responsibility of the **INSTALLER** to have some knowledge of finished floor thickness before proceeding.

- Use a LEVEL (6) to properly level the ROUGH (3) and SUPPORT (4) in all directions; vertical height of ROUGH (3) is determined by using the MIN/MAX finished floor marks on MUDGUARD (7)
- Verify that FITTING (2) attached to ROUGH (3) has clearance to make connections; adjust if necessary
- Use four wood SCREWS (8), not supplied, to secure the ROUGH (3) to SUPPORT (4). Required screw dimensions $\text{Ø}1/4'' \times 1-1/4''$ min length
- Connect water supply to preassembled FITTINGS (2) and check for leaks

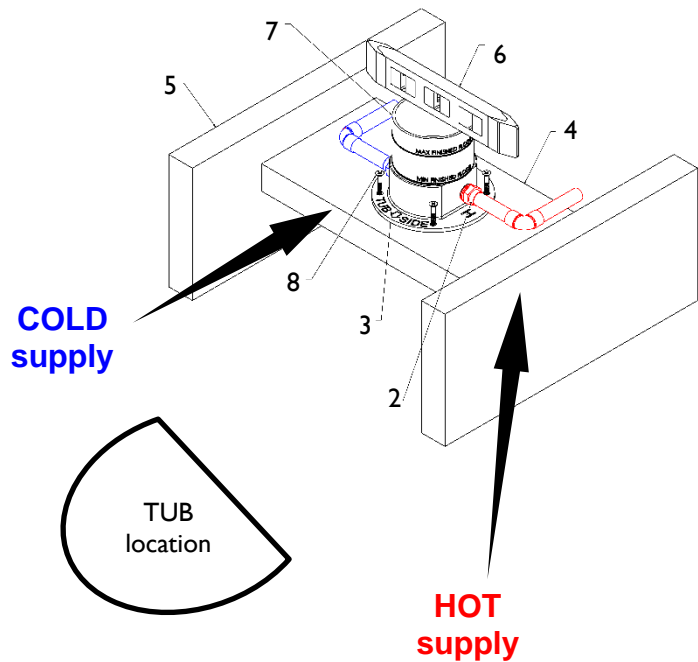

3

FINISHED FLOORING (on wood)

Important: It is the responsibility of the **INSTALLER** to have some knowledge of finished floor thickness before proceeding.

- Apply top floor SUBSTRATE (9) around MUDGUARD (7), the through hole shall be $\text{Ø}3-11/16''$ to $3-15/16''$ diameter
- Apply top floor COVERING (10) (e.g. tile, stone, etc...) to floor SUBSTRATE (9)
- Finished floor COVERING (10) must fall between the MIN/MAX marks on MUDGAURD (7) for proper installation of Floor Mounted Tub Filler Faucet

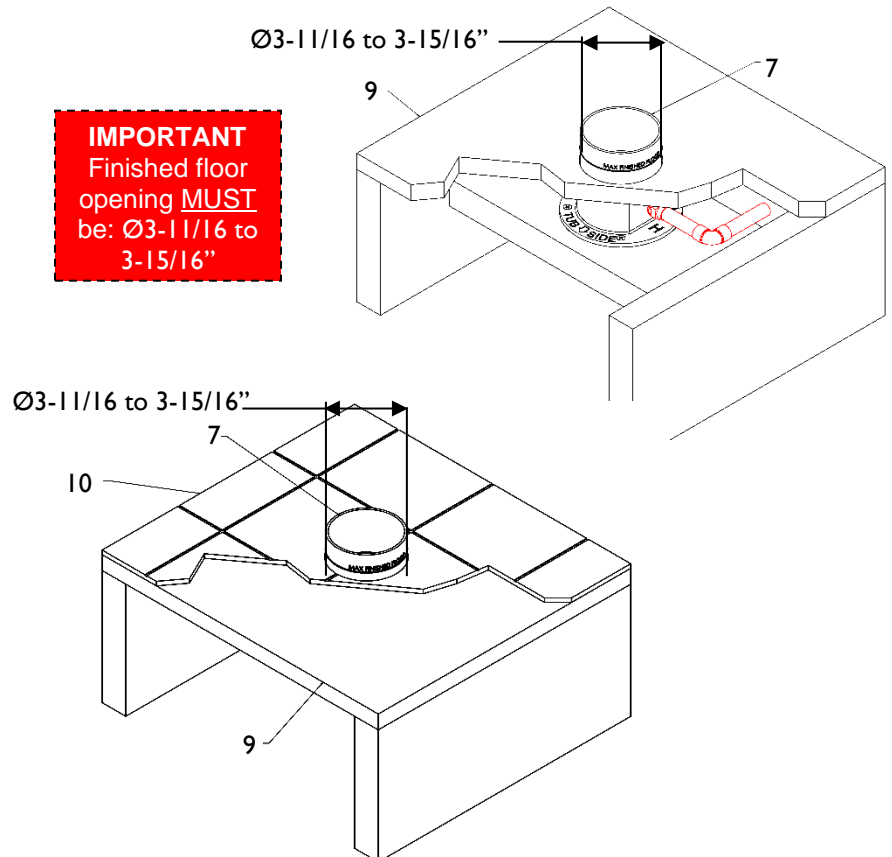

4 INSTALLING IN CONCRETE

- Determine location of tub & faucet prior to proceeding

Important: It is the responsibility of the **INSTALLER** to ensure that the floor rough is properly secured to all sub-flooring construction. All local building and plumbing codes and/or ordinances, shall be followed to confirm proper secure installation.

Important: It is the responsibility of the **INSTALLER** to have some knowledge of finished floor thickness before proceeding.

- Create a concrete MOUNTING (4) surface that is flat, level, and the correct depth below the surrounding concrete TOP (11) surface
- Determine the height of MOUNTING (4) surface by using the MIN/MAX finished floor marks on the MUDGUARD (7)
- Use ROUGH (3) as a template to mark drill hole locations
- Verify FITTINGS (2) attached to ROUGH (3) will have clearance to make connections; adjust if necessary
- Determine type of concrete SCREWS (8) or bolt necessary, not provided, and follow screw manufacturer's instructions. Required screw dimensions $\varnothing 1/4" \times 1-1/4"$ min length
- Use four concrete SCREWS (8) to secure the ROUGH (3) to MOUNTING (4) surface
- Connect water supply to preassembled FITTINGS (2) and check for leaks

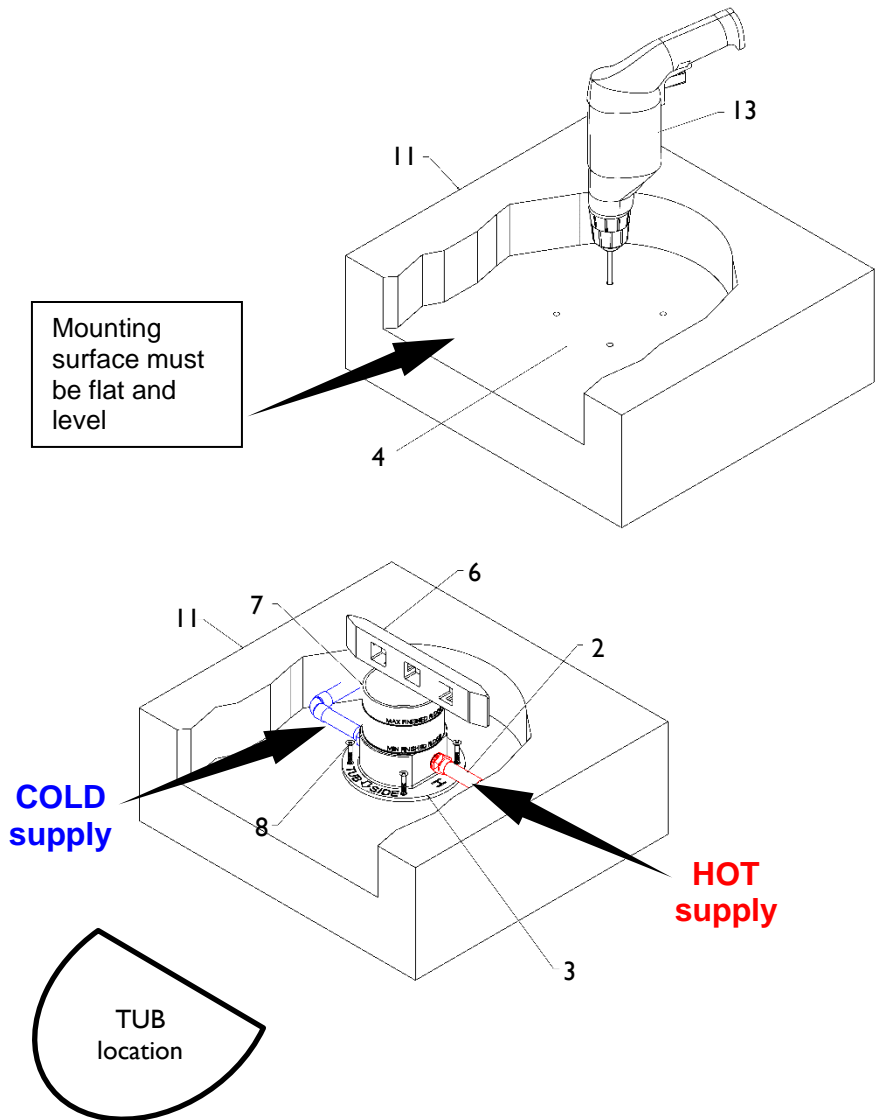

5 FINISHED FLOORING (on concrete)

Important: It is the responsibility of the **INSTALLER** to have some knowledge of finished floor thickness before proceeding.

- Cover ROUGH (3) with a LINER (14). Pour concrete FILLER (12) around MUDGUARD (7) encasing ROUGH (3) and filling to surrounding TOP (11) surface. (Liner not provided)
- Apply top floor COVERING (10) (e.g. tile, stone, etc...) onto concrete FILLER (12) and surrounding TOP (11) surface
- Finished floor COVERING (10) must fall between the MIN/MAX marks on MUDGAURD (7) for proper installation of Floor Mounted Tub Filler Faucet

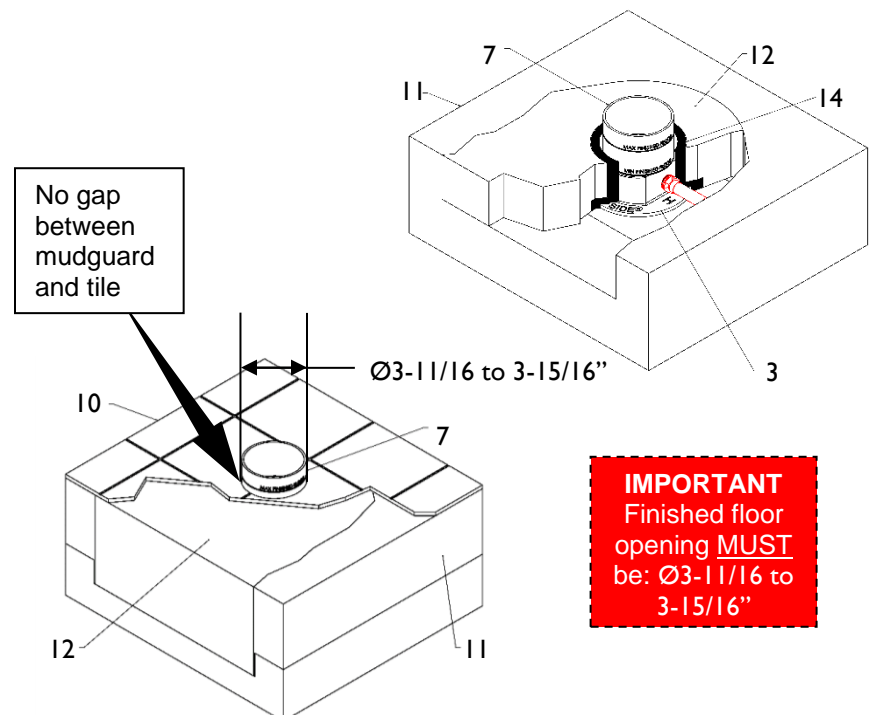

IMPORTANT
Finished floor opening **MUST** be: $\varnothing 3-11/16$ to $3-15/16$ "

ROUGH-IN DIMENSIONS

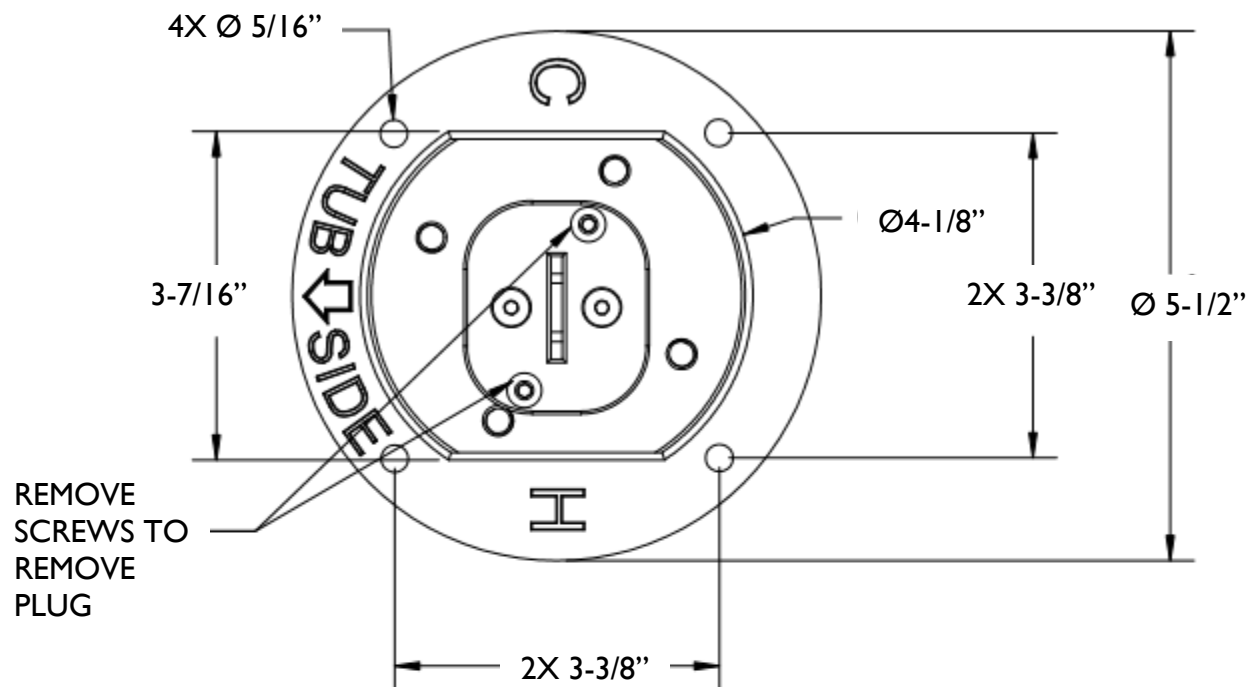

TOP VIEW

FRONT VIEW

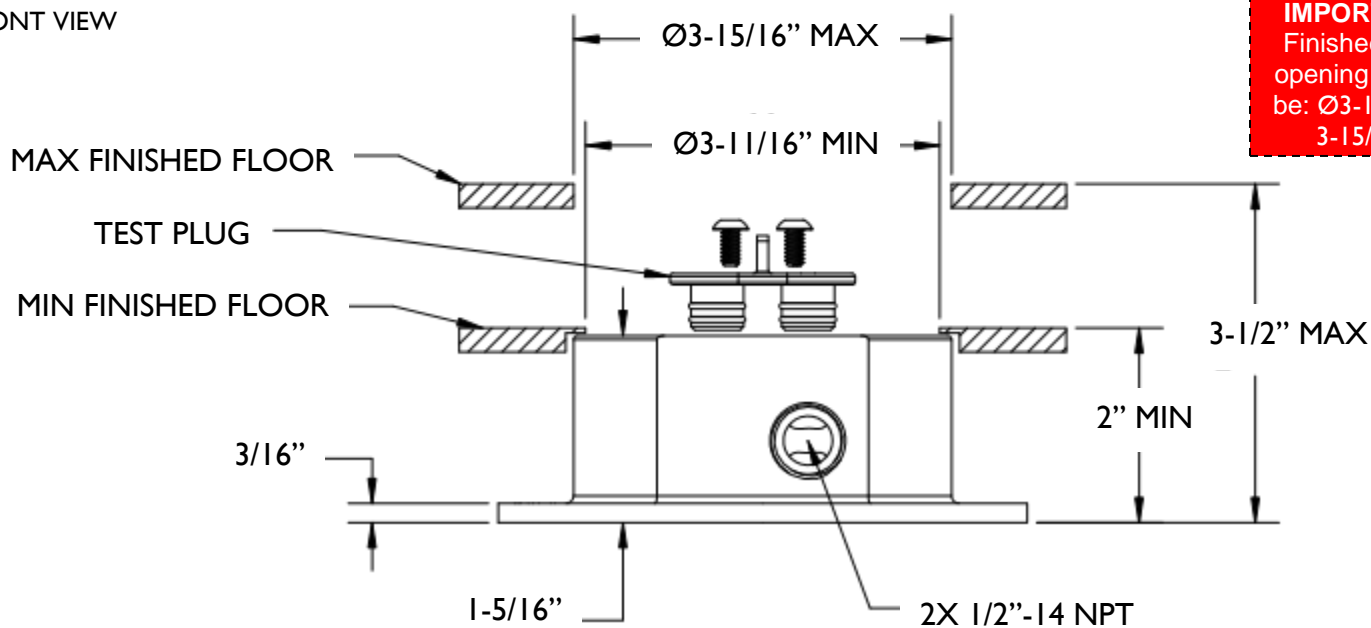

IMPORTANT
Finished floor opening MUST
be: Ø 3-11/16 to
3-15/16"