

Mirror Bentwood 30*72in

ENGLISH

- Do not dispose of any packaging or contents of the shipping carton until assembly is completed to avoid accidentally discarding small parts or hardware.

FRANÇAIS

- Ne jetez rien des produits d'emballage et du contenu de la boîte jusqu'à ce que l'assemblage soit terminé, afin d'éviter de jeter par mégarde de petites pièces ou des morceaux.

ESPAÑOL

- Para evitar desechar accidentalmente las partes pequeñas o las piezas de ferretería, no tirar el embalaje o contenido de la caja hasta que el ensamblaje esté completo.

Care Instructions:

- Dust often using a clean, soft, dry and lint-free cloth.
- Blot spills and wipe with a clean, damp cloth immediately.
- We do not recommend the use of chemical cleansers, abrasives or furniture polish on our lacquered finish.
- Hardware may loosen over time. Periodically check to make sure all connections are tight. Re-tighten if necessary.

Instructions d'entretien :

- Épousseter régulièrement avec un chiffon propre, doux et non pelucheux.
- Éponger immédiatement les liquides renversés et essuyer à l'aide d'un chiffon propre et humide.
- L'utilisation de produits nettoyants chimiques, d'abrasifs ou d'encaustiques sur nos finitions laquées n'est pas recommandée.
- Le matériel de fixation peut se desserrer avec le temps. Vérifiez régulièrement afin de vous assurer que tous les raccords sont bien serrés. Resserrez-les au besoin.

Instrucciones de cuidado:

- Limpiar el polvo con un trapo limpio, suave, seco y libre de pelusas.
- Secar los derrames de inmediato y limpiar con un trapo limpio y húmedo.
- Recomendamos no usar limpiadores químicos, abrasivos o lustramuebles sobre el acabado barnizado.
- Las piezas de ferretería pueden aflojarse con el tiempo. Controlar periódicamente que estén bien ajustadas. Si es necesario, volver a ajustarlas.

WARNING! Do not mount this item above cribs, beds, or changing tables.

MISE EN GARDE : Ne pas monter cet article au-dessus des berceaux, des lits ou des tables à langer.

ADVERTENCIA: No colocar este artículo sobre cunas, camas o cambiadores.

- The provided mounting hardware is meant for drywall and stud construction only. For other wall types, please consult your local hardware store for assistance in selecting the appropriate hardware.
- Le matériel de montage fourni est destiné uniquement à un montage mural ou sur montant. Pour les autres types de murs, consulter la quincaillerie locale pour obtenir de l'aide lors du choix du matériel approprié.
- Las piezas de ferretería para montaje se deben utilizar para montaje en viga o muro en seco únicamente. Para otros tipos de pared, pedir a la ferretería local que lo ayuden a seleccionar las piezas de ferretería adecuadas.

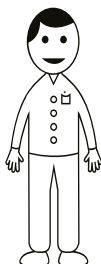
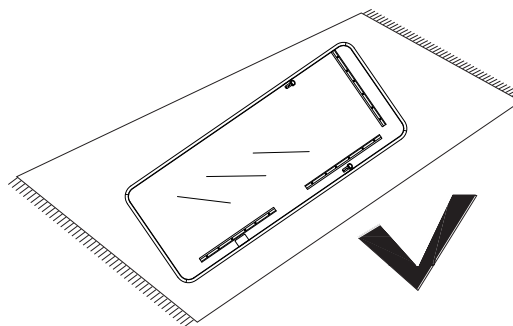
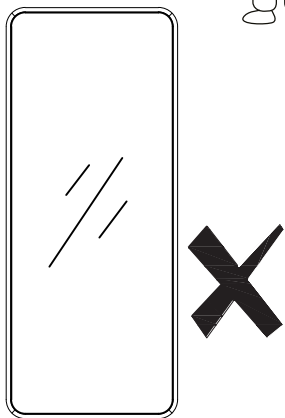
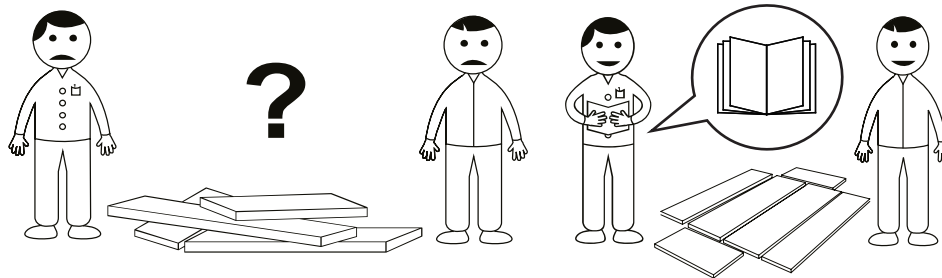

X2

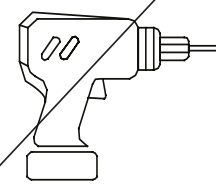
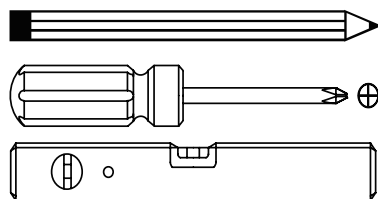

NOT INCLUDED / NON INCLUS / NO INCLUIDAS

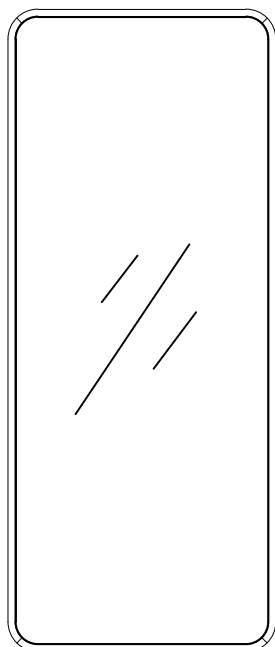

A



Ø4*38mm 12x

B



Ø 12*42mm 12x

C



Alum wall-side bracket 2x

Hardware - Wall mirror

A) Wall Mirror (installing to use alum metal bracket & provided anchor & screw)

1

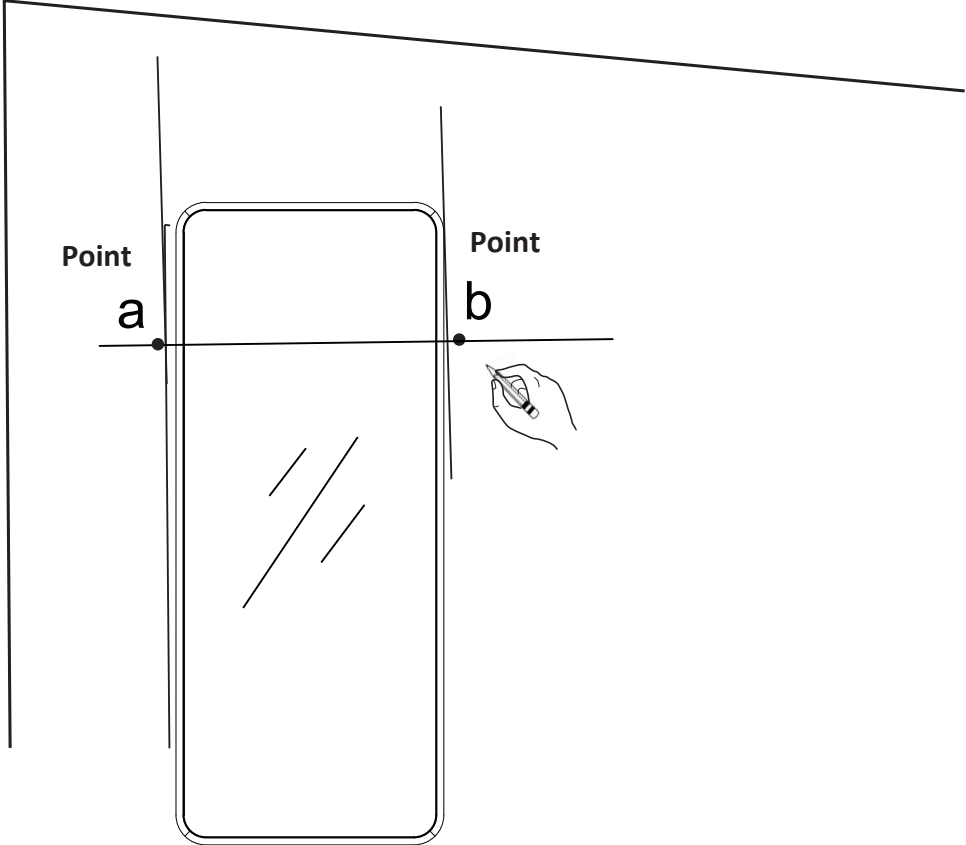

2

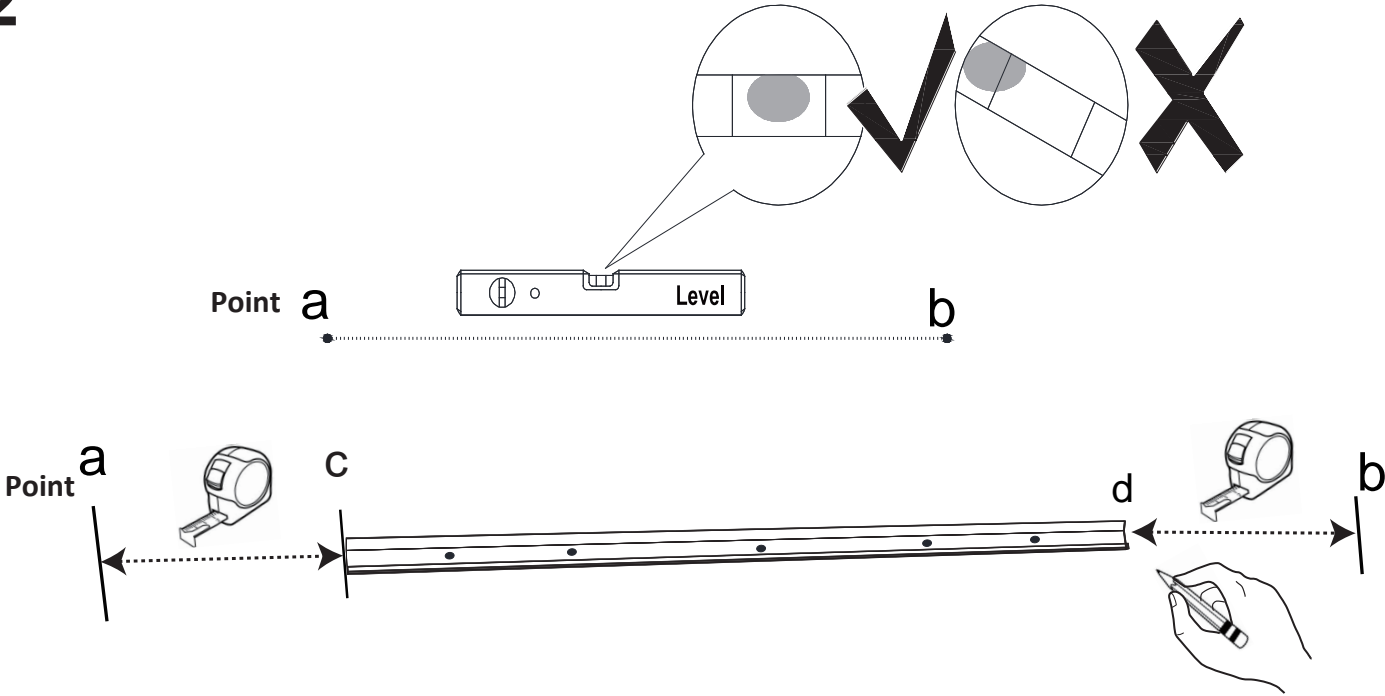

3

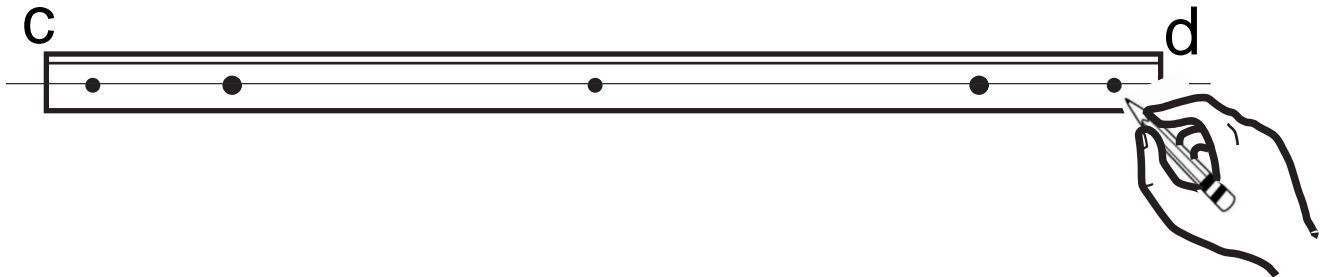

4



For stud mounting:
Montage sur montant :
Para el montaje en vigas:

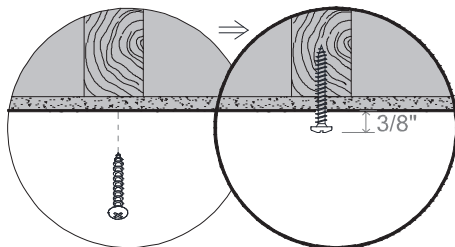

For non-stud mounting:
Montage sur cloison sèche
Para montaje que no sea en vigas:

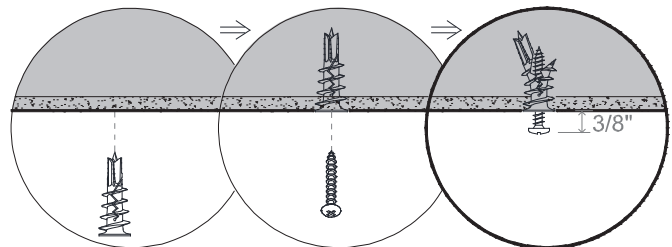

5

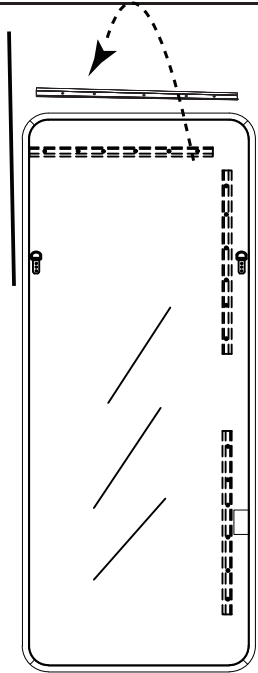

6

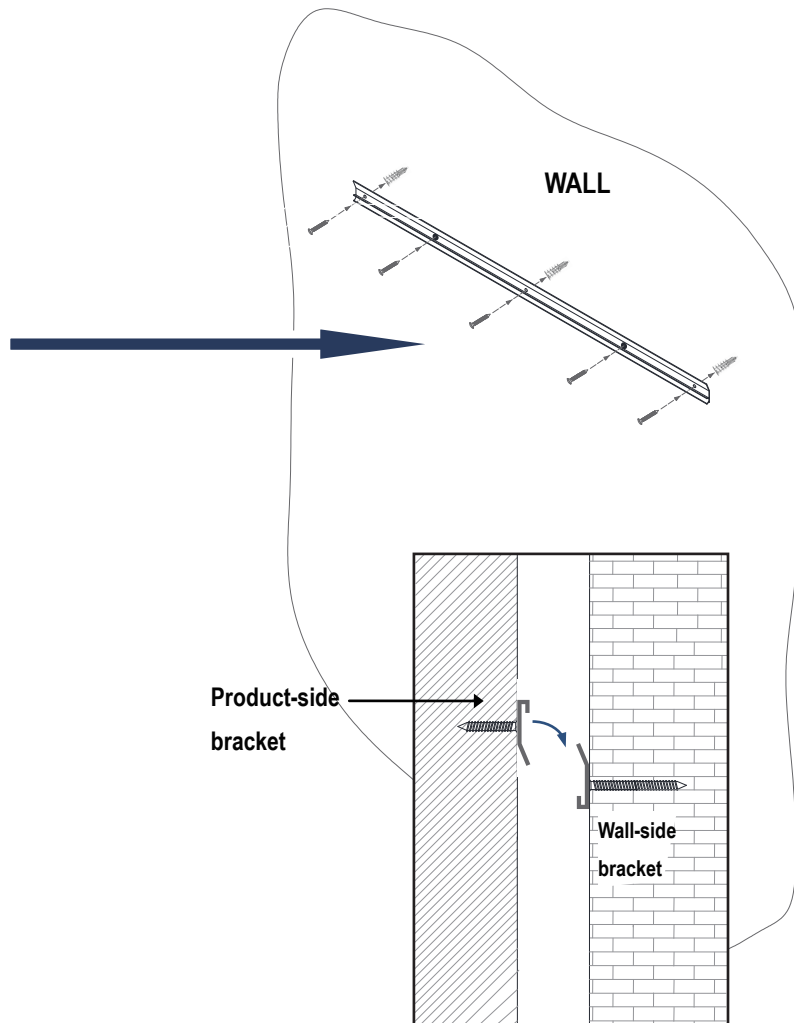
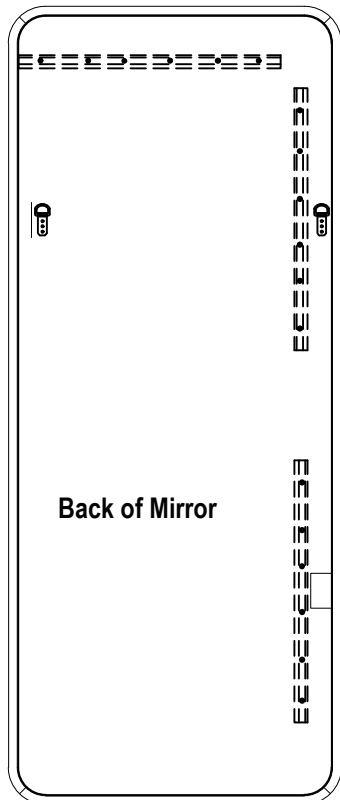

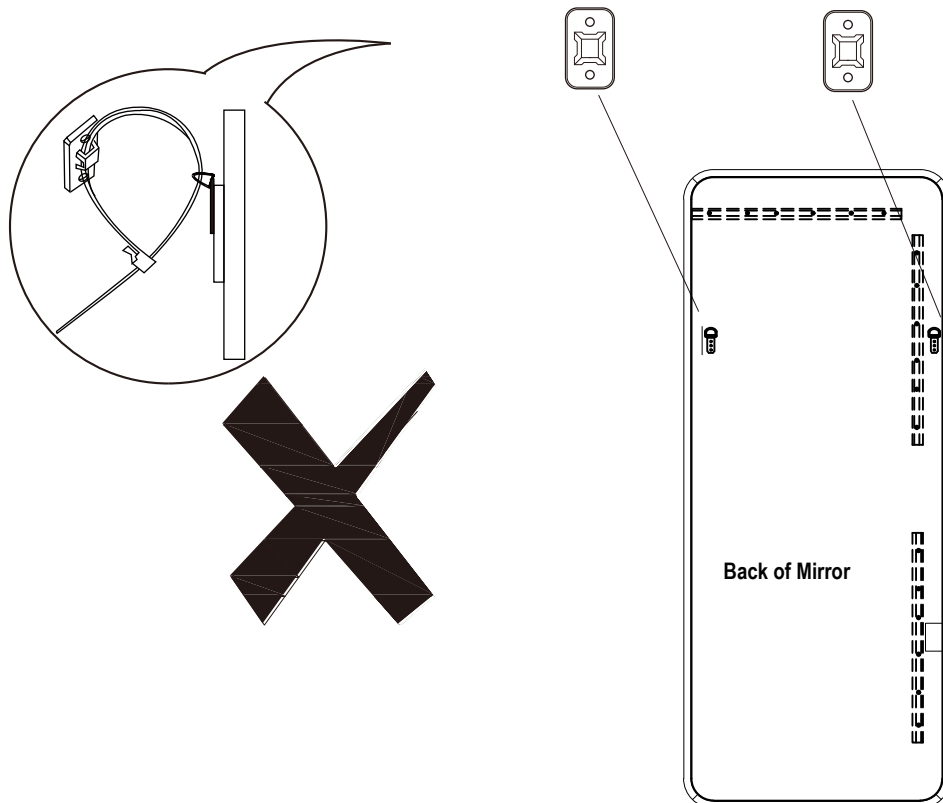
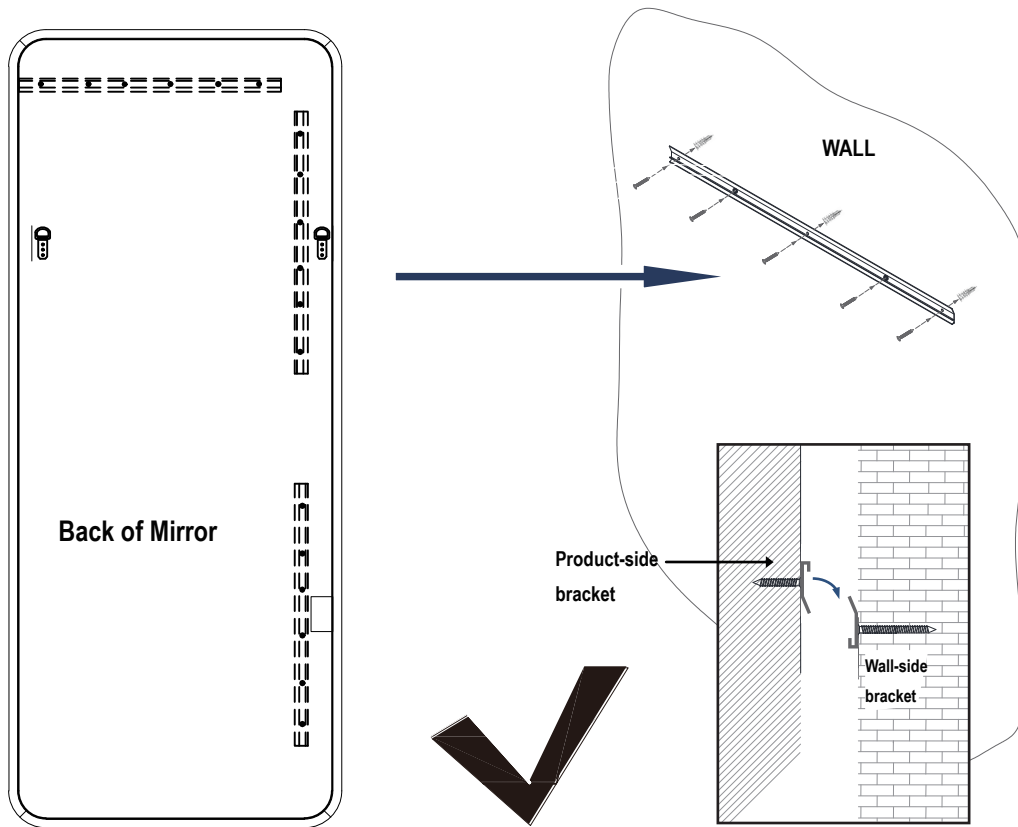

- ⚠️ PLASTIC BRACKET AND NYLON STRAP CAN NOT BE USED FOR WALL MIRROR MODE
- ⚠️ LE SUPPORT EN PLASTIQUE ET LA SANGLE EN NYLON NE PEUVENT PAS SERVIR à SUSPENDRE LE MIROIR MURAL.
- ⚠️ EL SOPORTE PLÁSTICO Y LA CORREA DE NYLON NO SE PUEDEN USAR PARA EL MODO ESPEJO DE PARED

B) Floor Mirror (Installing the Provided Anti-Tip Kit):

Secure the Floor item to wall to help prevent accidentally tip over

Please must install the provided anti-tip kit to prevent the item from accidentally falling and causing injury or damage.

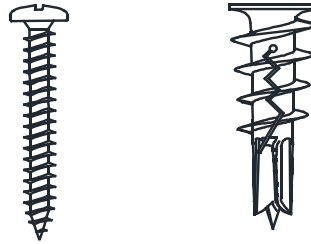
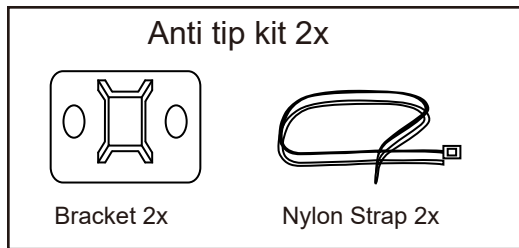

Ø4*38mm 4x

Ø12*42mm 4x

1

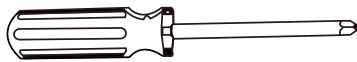
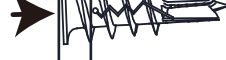
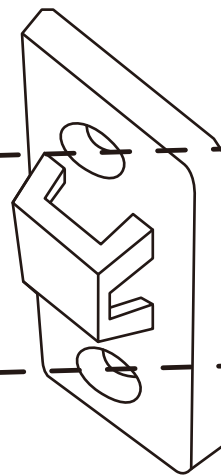

2

mirror

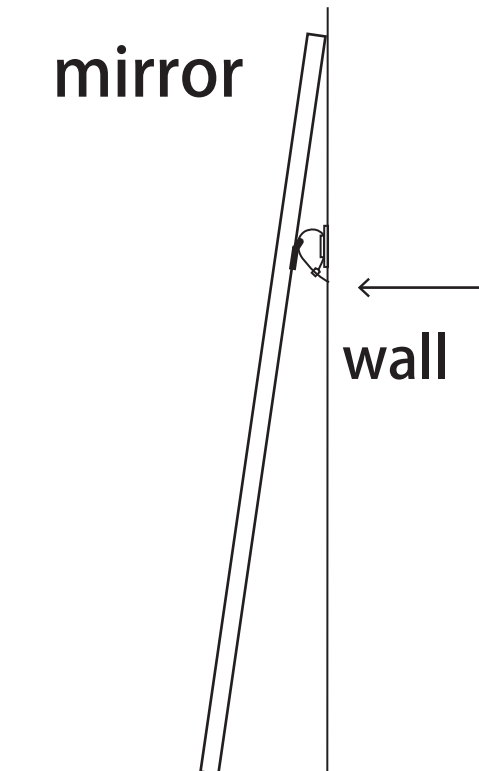

wall

Bracket

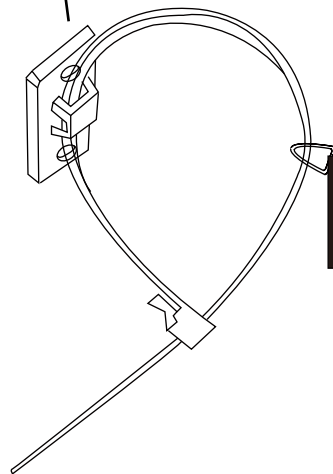

back of mirror